



## Two Channel Gas Detectors E2632



### Features

- Simultaneous detection of two gases
- Accurate and stable measurement
- Wall-mount IP65 protected housing
- Visual and acoustic alarms
- Two output relays for alarm / ventilation control

### Specifications

Sensor type	Depends on detected gases available are: metal oxide sensors, electrochemical sensors
Sampling method	Diffusion
Signal update	Every 1 second
Warm-up time	≤ 1 min
Power supply	24 VDC/AC ±20% (default) or 230 VAC (optional)
Power consumption	< 4 VA
Digital interface	UART
Output relays	2 relays with switch-over contact (SPDT), 250 VAC / 30 VDC, 5 A max
Alarm set-points	Depending on target gas and application
Alarms	Blinking LED, buzzer 85 dB
Enclosure	Grey wall-mount ABS plastic, protection class IP65
Dimensions	H123 × W201 × D55 mm
Output cable	Max Ø8 mm
Operating environment	Residential, business and industrial indoor spaces
Operating conditions	15...95 %RH, atmospheric pressure ±10% Non-ATEX rated areas temperature depends on the sensor

### Dimensions

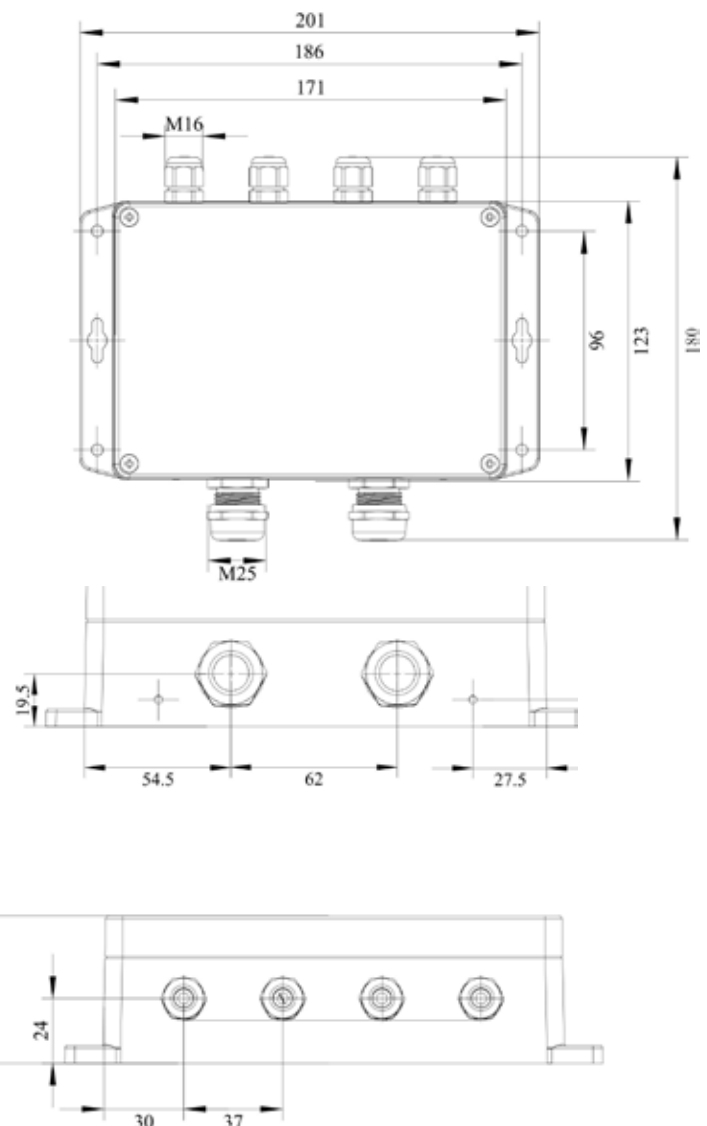

## Connection diagram

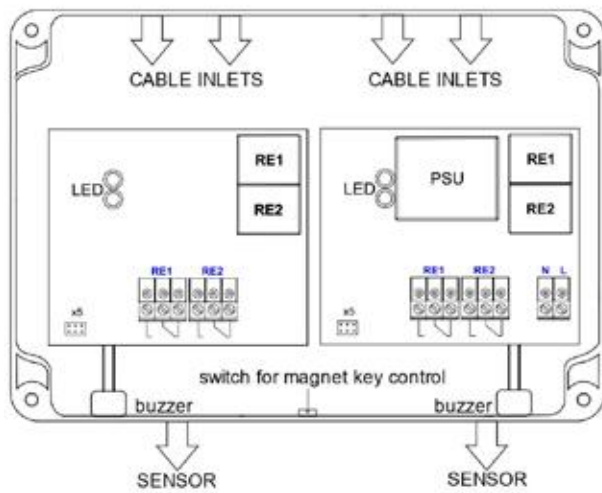

### Terminals

<b>RE1 NO</b>	Relay 1, normally open terminal
<b>RE1 COM</b>	Relay 1, common terminal
<b>RE1 NC</b>	Relay 1, normally closed terminal
<b>RE2 NO</b>	Relay 2, normally open terminal
<b>RE2 COM</b>	Relay 2, common terminal
<b>RE2 NC</b>	Relay 2, normally closed terminal
<b>L</b>	90...265 VAC Phase (optional 24 VAC / VDC)
<b>N</b>	90...265 VAC Neutral (optional 24 VAC / VDC)

## Magnet key

