

PRODUCT-DETAILS

# KLC XT2-XT4 KEY LOCK RONIS SE.OP.xC.BRE.

## KLC XT2-XT4 KEY LOCK RONIS SE.OP.xC.BRE.

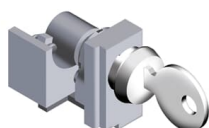

### General Information

Extended Product Type	KLC XT2-XT4 KEY LOCK RONIS SE.OP.xC.BRE.
Product ID	1SDA066599R1
EAN	8015644004880
Catalog Description	KLC XT2-XT4 KEY LOCK RONIS SE.OP.xC.BRE.
Long Description	KEY LOCK RONIS 622 SEVERAL IN OPEN WITH KEY WITHDRAWABLE IN OPEN POSITION FOR C.BREAKER XT2-XT4

### Ordering

EAN	8015644004880
Minimum Order Quantity	1 piece
Customs Tariff Number	85389099

### Dimensions

Product Net Width	150 mm
Product Net Height	20 mm
Product Net Depth / Length	200 mm
Product Net Weight	0.071 kg

### Container Information

Package Level 1 Units	1 piece
Package Level 1 Width	150 mm
Package Level 1 Height	20 mm
Package Level 1 Depth / Length	200 mm
Package Level 1 Gross Weight	0.075 kg
Package Level 1 EAN	8015644004880

### Additional Information

Configuration Type	Loose or configurable
Order Multiple	1 piece
Product Main Type	Accessories for Tmax XT
Product Name	Accessory
Product Type	ACC
Standards	IEC 60947-2
Suitable For	XT2, XT4
Suitable for Product Class	SACE Tmax XT

### Certificates and Declarations (Document Number)

Data Sheet, Technical Information	1SDC210100D0204 1SDC210099D0204
Instructions and Manuals	1SDH000719R0612

### Classifications

ETIM 6	EC002498 - Accessories for low-voltage switch technology
ETIM 7	EC002498 - Accessories for low-voltage switch technology
Object Classification Code	Q
UNSPSC	39120000
WEEE Category	5. Small Equipment (No External Dimension More Than 50 cm)

### Categories

Low Voltage Products and Systems → Circuit Breakers → Moulded Case Circuit Breakers → Accessories for Tmax XT

