



## Data sheet

## Elbow fitting LJK

 Temperature range  
 -10 ... +60°C

 Operating pressure  
 -0.95 ... 8 bar

 **Note**  
 For suction cup VAS/VASB

- Rerouting the air connection
- Swivel joint rotatable 360°
- For decoupling from mounting thread



## General technical data

Size	M5	G1/8	G1/4
Design	Swivel fitting with female thread		
Operating medium	Atmospheric air based on ISO 8573-1:2010 [7:-:-]		
Mounting position	Any		
Type of mounting	Option for mounting the lateral air connection on the male thread of the hollow bolt		
Vacuum connection	M5	G1/8	G1/4
Operating pressure [bar]	-0.95 ... 8		

## Environmental conditions

Size	M5	G1/8	G1/4
Swivel fitting	Die-cast zinc		
Seals	Nitrile rubber and steel/nitrile rubber		
Note on materials	Free of copper, PTFE and silicone		
Ambient temperature [°C]	-10 ... +60		
Corrosion resistance class CRC <sup>1)</sup>	2		

1) Corrosion resistance class CRC 2 to Festo standard FN 940070

Moderate corrosion stress. Indoor applications in which condensation can occur. External visible parts with primarily decorative surface requirements which are in direct contact with a normal industrial environment.

## Dimensions

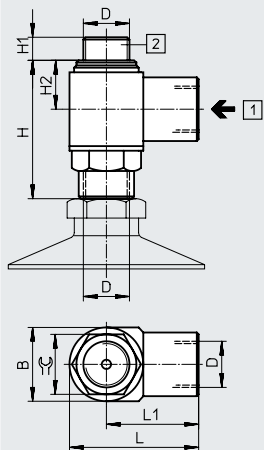

[1] Air connection (vacuum)

[2] Mounting thread

Vacuum connection	B	D	H	H1	H2	L	L1	☉
M5	10	M5	20.3	3.8	7.5	17.5	12.5	8
G1/8	16	G1/8	30	5	10.6	28	20	13
G1/4	20	G1/4	39	8	13.5	36	26.5	17

## Ordering data

Vacuum connection	Part no.	Type
M5	151 783	LJK-M5-I/I
G1/8	151 784	LJK-1/8-I/I
G1/4	151 785	LJK-1/4-I/I